

FISHER FINE ARTS BUILDING STUDY

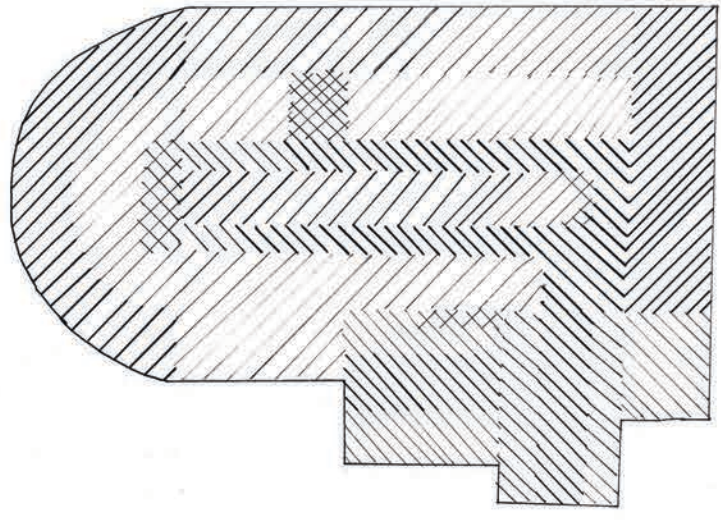

PART I

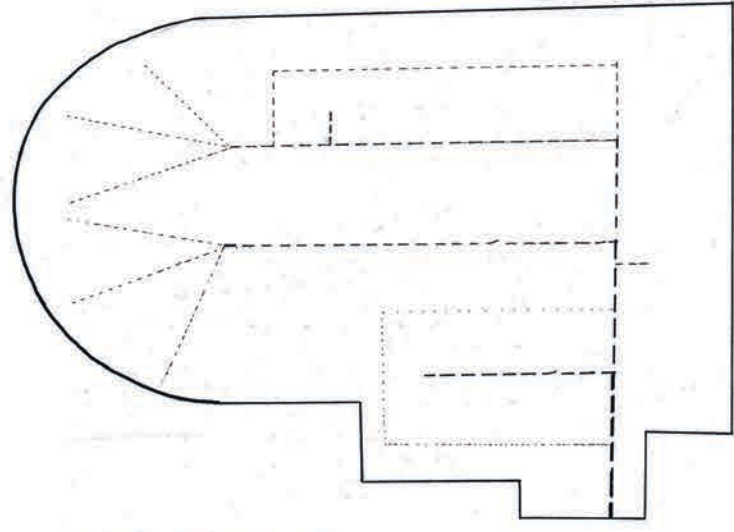

DIAGRAM

IN THE FISHER FINE ARTS LIBRARY, A MAJOR ASPECT IN DESIGN IS THE SEPARATION OF PRIVATE SPACE AND PUBLIC SPACE, OR REST SPACE AND SPACE OF MOVEMENT. THE FURTHER ONE TRAVELS INTO THE SPACE, THE LESS CIRCULATION OF MOVEMENT OCCURS; THE ALCOVES IN THE BACK ARE MOST PRIVATE, WHILE READING TABLES TO THE FRONT ARE MOST PUBLIC. ALTHOUGH FURNESS USES INTRICATE, ORNAMENTAL DESIGN, THE CONCEPT OF THE BUILDING IS STILL KEPT SIMPLE.

